

1.1 ProMinent® Beta® b 4 & 5 Metering Pumps

1.1.2 Technical Data Beta®

pump type	Max. Pump Capacity at Maximum Back Pressure			Max. Pump Capacity at Medium Back Pressure			Stroke Freq	Connector Sizes Outer R x Inner R	Suction Lift**	Delivery Weight PP, NP PC, TT	SS
	bar	l/h	ml/stroke	bar	l/h	ml/stroke					
BT4b 1000	10	0.74	0.069	5.0	0.82	0.076	180	6 x 4	6.0**	2.9	3.6
BT4b 0700 ***	7	0.8	0.074	3.5	0.8	0.074	180	6 x 4	6.0**	2.9	3.6
BT4b 0400 ***	4	0.84	0.078	2.0	0.84	0.078	180	6 x 4	6.0**	2.9	3.6
BT4b 2001	20	0.96	0.089	10.0	1.5	0.13	180	6 x 3	6.0**	3.1	3.9
BT4b 1601	16	1.1	0.10	8.0	1.4	0.13	180	6 x 4	6.0**	3.1	3.9
BT4b 1001 ***	10	1.3	0.12	5.0	1.5	0.14	180	6 x 4	6.0**	3.1	3.9
BT4b 0701 ***	7	1.4	0.13	3.5	1.5	0.14	180	6 x 4	6.0**	3.3	4.4
BT4b 0401 ***	4	1.5	0.14	2.0	2.0	0.18	180	6 x 4	6.0**	2.9	3.6
BT4b 2002	20	1.7	0.16	2.8	0.26	0.13	180	6 x 3	6.0**	2.9	3.6
BT4b 1602	16	2.2	0.20	8.0	2.5	0.24	180	6 x 4	6.0**	2.9	3.6
BT4b 1002 ***	10	2.4	0.22	5.0	2.8	0.26	180	6 x 4	6.0**	3.1	3.9
BT4b 0702 ***	7	2.6	0.24	3.5	3.1	0.29	180	6 x 4	6.0**	3.1	3.9
BT4b 0402 ***	4	2.8	0.26	2.0	3.9	0.36	180	6 x 4	3.0**	3.1	3.9
BT4b 1604	16	3.6	0.33	8.0	4.3	0.40	180	6 x 4	2.0**	3.3	4.4
BT4b 1004 ***	10	3.9	0.36	5.0	4.7	0.44	180	6 x 4	5.0**	2.9	3.6
BT4b 0704 ***	7	4.2	0.39	3.5	5.1	0.47	180	6 x 4	5.0**	2.9	3.6
BT4b 0404 ***	4	4.5	0.42	2.0	5.6	0.52	180	6 x 4	5.0**	2.9	3.6
BT4b 0708	7	7.1	0.66	3.5	8.4	0.78	180	8 x 5	6.0**	3.1	3.9
BT4b 0408 ***	4	8.3	0.77	2.0	10.0	0.93	180	8 x 5	4.0**	3.1	3.9
BT4b 0413	4	12.3	1.14	2.0	14.2	1.31	180	8 x 5	3.0**	2.9	3.6
BT4b 0220	2	19.0	1.76	1.0	20.9	1.94	180	12 x 9	2.0**	2.9	3.6
BT5b 2504	25	2.9	0.27	12.5	3.7	0.34	180	8 x 4	4.0**	3.1	3.9
BT5b 1008	10	6.8	0.63	5.0	8.3	0.76	180	8 x 5	3.0**	3.3	4.4
BT5b 0713	7	11.0	1.02	3.5	13.1	1.21	180	8 x 5	3.0**	4.5	5.3
BT5b 0420	4	17.1	1.58	2.0	19.1	1.77	180	12 x 9	3.0**	4.7	5.8
BT5b 0232	2	32.0	2.96	1.0	36.2	3.35	180	12 x 9	2.0**	5.1	6.6

Beta b® Metering Pumps with self-bleeding dosing head *

BT4b 1601	16	0.59	0.055	8.0	0.80	0.072	180	6 x 4	1.8**	2.9	-
BT4b 1001	10	0.72	0.067	5.0	0.60	0.08	180	6 x 4	2.1**	2.9	-
BT4b 0701	7	0.84	0.078	3.5	1.12	0.10	180	6 x 4	2.7**	3.1	-
BT4b 0401	4	0.90	0.083	2.0	1.2	0.11	180	6 x 4	2.0**	3.1	-
BT4b 2002	20	0.78	0.07	10.0	1.8	0.17	180	6 x 3	2.0**	3.1	-
BT4b 1602	16	1.4	0.13	8.0	1.74	0.174	180	6 x 4	2.0**	3.3	-
BT4b 1002	10	1.7	0.16	5.0	2.0	0.072	180	6 x 4	1.8**	2.9	-
BT4b 0702	7	1.8	0.17	3.5	2.2	0.20	180	6 x 4	2.1**	2.9	-
BT4b 0402	4	2.1	0.19	2.0	2.5	0.23	180	6 x 4	2.7**	3.1	-
BT4b 1604	16	2.7	0.25	8.0	3.6	0.33	180	6 x 4	2.0**	3.1	-
BT4b 1004	10	3.3	0.30	5.0	3.9	0.36	180	6 x 4	2.0**	3.1	-
BT4b 0704	7	3.6	0.33	3.5	4.0	0.37	180	6 x 4	2.0**	3.3	-
BT4b 0404	4	3.9	0.36	2.0	4.2	0.39	180	6 x 4	1.8**	2.9	-
BT4b 0708	7	6.6	0.61	3.5	7.5	0.69	180	8 x 5	2.1**	2.9	-
BT4b 0408	4	7.5	0.64	2.0	8.1	0.77	180	8 x 5	2.7**	3.1	-
BT4b 0413	4	10.8	1.0	2.0	12.6	1.17	180	8 x 5	2.0**	3.1	-
BT4b 0220	2	16.2	1.50	1.0	18.0	1.67	180	12 x 9	2.0**	3.3	-
BT5b 1008	10	6.3	0.58	5.0	7.5	0.69	180	8 x 5	3.0**	4.5	-
BT5b 0713	7	10.5	0.97	3.5	12.3	1.14	180	8 x 5	2.5**	4.5	-
BT5b 0420	4	15.6	1.44	2.0	17.4	1.61	180	12 x 9	2.5**	4.7	-

Beta® pumps with liquid ends for highly viscous media have 10-20 % less metering capacity and are not self-priming. G 3/4-DN connector with d16-DN10 nozzle union.

* The values given in the capacity data tables are guaranteed minimum values, using medium hardness water at room temperature. Bypass bleed size 6x4 all sizes.

** Suction lift readings when liquid end and suction tubing are full, or for self-degassing liquid end when the suction tubing contains air.

*** Reduced pressure 4, 7 and 10 bar pump types are available for specialised applications, e.g. for use in swimming pool systems.

**** 6 mm inner diameter in stainless steel version.



1.1 ProMinent® Beta® b 4 & 5 Metering Pumps

1.1.3 Identity Code & Pricing for Beta® b 4 & 5

BT4b Beta® version b

BT4b 1000,1601, 1602, 1604
also 2001* 1001, 0701, 0401
2002* 1002, 0702, 0402
1004, 0704, 0404

PP
PV
NP
TT
SS
PP
PV
NP
TT
SS

BT5b 1008, 0713, 0420
also 2504*

Note: 2504*, 2002*, 2001* only NP & SS

PP
PV
NP
TT
SS
PP
PV
NP
TT
SS

BT4b 0708, 0413, 0220
also 0408

BT5b 0232

Liquid End Materials / Seals *** Note: not all stocked *** 1004 ONLY available in NPT ***

- PPE Polypropylene/EPDM
- PPB Polypropylene/Viton (FPM-B) *not stocked FPM-B = Fluorine Rubber*
- NPE Plexiglass/EPDM *not stocked*
- NPB Plexiglass/Viton
- PVT PVDF/PTFE, for L/E type 2 **not 0232** & type 4 **only 1004/1604, 0708/1008, 0413/0713, 0220/420**
- TTT PTFE/PTFE
- SST Stainless Steel 1.4571/PTFE

Liquid End Version

- 0 Non bleed, no valve springs, **ONLY for TT, SS and type 0232 PVT & PPE**
- 1 Non bleed, with valve springs, **ONLY for TT, SS and type 0232**
- 2 Bleed function, no valve springs for PP, NP, & PVT only - **not type 0232 EXCEPT NPB2**
- 3 Bleed function, with valve springs for PP, NP, & PVT only - **not type 0232**
- 4 Version for highly viscous media, **only PVT type 1604, 0708, 1008, 0413, 0713, 0220, 0420**
- 7 PVT Self bleed (SER) no bypass **NOT 1000, 1601, 0232**
- 9 Self bleed, (SEK) **for PP, NP only all sizes EXCEPT type 1000 and 0232**

Design

- 0 Housing RAL 5003, Hood RAL 2003

Hydraulic Connections

- 0 Standard according to technical data

Logo

- 0 With ProMinent Logo

Power Supply

- U 100 - 230V, ±10%, 50/60 Hz
- M 12-24V DC (only BT4b) with 2 m open-ended cable **ONLY**
- N 24V DC with 2 m open-ended cable **ONLY**

Cable & Plug

- C 2m Australian
- 1 2m Open ended Cable for 12-24V pumps **ONLY**

Relay

- 0 No Relay
- 1 Fault indicating relay (N/C) (changeover relay) **Preferred**
- 3 Fault indicating relay (N/O) (changeover relay)
- 4 As for 1 + pacing relay (1 input each)
- 5 As for 3 + pacing relay (1 input each)

Accessories

- 0 No accessories
- 1 Tube FV & IV - **NOT for PTFE, SS or HV**

Electronic Locking

- 0 No lock
- 1 With electronic lock

Control Variant

- 0 Standard
- A Milliamp

Pause

- 0 Standard

Options on Request

- 0 Standard

Prepack Option

- P* See options -

Prepacks = P*

P0 - includes 5m of delivery and 2m suction tube

P2 - includes 5m of delivery and 2m suction tube
a 2m Control Cable if required.

P5 - as P2 but with 5m control Cable

PX - as P2 but with 10m control Cable

Note: 2504, 2001, 2002, 1601, 1602, 1605 pumps are supplied with 5.0m PTFE tube (in appropriate size) and fittings to suit, other tube is available on request.

BT4b 1601 PPE 2 0 0 0 U C 0 1 0 0 0 0 P0



1.1 ProMinent® Beta® b 4 & 5 Metering Pumps

1.1.4 Technical Data for Beta® a 4 & 5 – CAN Bus ONLY

pump type	Max. Pump Capacity at Maximum Back Pressure			Max. Pump Capacity at Medium Back Pressure			Stroke Freq	Connector Sizes Outer R x Inner R	Suction Lift**	Delivery Weight PP, NP PC, TT	SS
	bar	l/h	ml/ stroke	bar	l/h	ml/ stroke					
Beta®							strokes/ min.	mm	m Wc	kg	kg
BT4a 1000***	10	0.74	0.07	5	0.82	0.08	180	6 x 4	6.0**	2.9	3.6
BT4a 1601***	16	1.1	0.10	8	1.4	0.13	180	6 x 4	6.0**	2.9	3.6
BT4a 1602***	16	2.1	0.19	8	2.5	0.24	180	6 x 4	6.0**	2.9	3.6
BT4a 1005***	10	4.4	0.41	5	5.0	0.46	180	8 x 5****	6.0**	3.1	3.9
BT4a 0708***	7	7.1	0.66	3.5	8.4	0.78	180	8 x 5	6.0**	3.1	3.9
BT4a 0413	4	12.3	1.14	2	14.2	1.31	180	8 x 5	3.0**	3.1	3.9
BT4a 0220	2	19.0	1.76	1	20.9	1.94	180	12 x 9	2.0**	3.3	4.4
BT5a 1605	16	4.1	0.38	8	4.9	0.45	180	8 x 5****	6.0**	4.5	5.3
BT5a 1008	10	6.8	0.63	5	8.3	0.76	180	8 x 5	6.0**	4.5	5.3
BT5a 0713	7	11.0	1.02	3.5	13.1	1.21	180	8 x 5	4.0**	4.5	5.3
BT5a 0420	4	17.1	1.58	2	19.1	1.77	180	12 x 9	3.0**	4.7	5.8
BT5a 0232	2	32.0	2.96	1	36.2	3.35	180	12 x 9	2.0**	5.1	6.6
Beta a® Metering Pumps with self-bleeding dosing head *											
BT4a 1601	16	0.59	0.06	8	0.78	0.07	180	6 x 4	1.8**	2.9	–
BT4a 1602	16	1.4	0.13	8	1.7	0.16	180	6 x 4	2.1**	2.9	–
BT4a 1005	10	3.6	0.33	5	4.0	0.37	180	8 x 5	2.7**	3.1	–
BT4a 0708	7	6.6	0.61	3.5	7.5	0.69	180	8 x 5	2.0**	3.1	–
BT4a 0413	4	10.8	1.00	2	12.6	1.17	180	8 x 5	2.0**	3.1	–
BT4a 0220	2	16.2	1.50	1	18.0	1.67	180	12 x 9	2.0**	3.3	–
BT5a 1605	16	3.3	0.31	8	3.8	0.35	180	8 x 5	3.0**	4.5	–
BT5a 1008	10	6.3	0.58	5	7.5	0.69	180	8 x 5	3.0**	4.5	–
BT5a 0713	7	10.5	0.97	3.5	12.3	1.14	180	8 x 5	2.5**	4.5	–
BT5a 0420	4	15.6	1.44	2	17.4	1.61	180	12 x 9	2.5**	4.7	–

Beta® pumps with liquid ends for highly viscous media have 10-20 % less metering capacity and are not self-priming. G 3/4-DN connector with d16-DN10 nozzle union.

* The values given in the capacity data tables are guaranteed minimum values, using medium hardness water at room temperature. Bypass bleed size 6x4 all sizes.

** Suction lift readings when liquid end and suction tubing are full, or for self-degassing liquid end when the suction tubing contains air.

*** Reduced pressure 4, 7 and 10 bar pump types are available for specialised applications, e.g. for use in swimming pool systems.

Further information on request.

**** 6 mm inner diameter in stainless steel version.

Materials on each Model in Contact with Chemicals

	Dosing head	Suction/pressure connector	Seals	Balls
PPE	Polypropylene	Polypropylene	EPDM	ceramic
PPB	Polypropylene	Polypropylene	FPM (Viton®)	ceramic
PCE	PVC	PVC	EPDM	ceramic
PCB	PVC	PVC	FPM (Viton®)	ceramic
NPE	Acrylic	PVC	EPDM	ceramic
NPB	Acrylic	PVC	FPM (Viton®)	ceramic
PVT	PVDF	PVDF	PTFE	ceramic
TTT	PTFE with carbon	PTFE with carbon	PTFE	ceramic
SST	stainless steel no. 1.4404	stainless steel no. 1.4404	PTFE	ceramic

Self-degassing version available in PP and NP only. Supplied with Hastelloy valve springs, PVDF valve core.

Dosing diaphragm with PTFE-coating.

Viton® is a registered trademark of DuPont Dow Elastomers.

Reproducible dosing accuracy ±2 % under correct conditions (see operating instructions).

Ambient temperature -10 °C to +45 °C.

Mean power consumption: Type 1000-0220: 17 W / Type 1605-0232: 22 W

Type of enclosure: IP 65, insulation class F

Metering Pumps supplied with mains power cable (2 m) and plug, hose/pipe connector set as tables.



1.1 ProMinent® Beta® a 4 & 5 Metering Pumps

1.1.5 Identity Code & Pricing for Beta® a 4 & 5 – CAN Bus ONLY

BT4a Beta® version a

BT4a 1000, 1601, 1602, also 0700, 0400 1001, 0701, 0401 1002, 0702, 0402	PPE PVT NPB TTT SST	BT5a 1605, 1008, 0713, 0420	PPE PVT NPB TTT SST
BT4a 1005, 0708, 0413, 0220 also 0405, 0705 0408	PPE PVT NPB TTT SST	BT5a 0232	PPE PVT NPB TTT SST

Liquid End Materials / Seals *** Note: not all stocked ***

PPE	Polypropylene/EPDM
PPB	Polypropylene/Viton (FPM-B) <i>not stocked</i> FPM-B = Fluorine Rubber
NPE	Plexiglass/EPDM <i>not stocked</i>
NPB	Plexiglass/Viton
PVT	PVDF/PTFE, for L/E type 2 <i>not 0232</i> & type 4 <i>only 1005/1605, 0708/1008, 0413/0713, 0220/420</i>
TTT	PTFE/PTFE
SST	Stainless Steel 1.4404/PTFE

Liquid End Version

- 0** Non bleed, no valve springs, **ONLY available for TT, SS and type 0232 PVT & PPE**
- 1** Non bleed, with valve springs, **ONLY available for TT, SS and type 0232 ONLY EXCEPT NPB2**
- 2** Bleed function, no valve springs for PP & PVT - **NOT type 0232**
- 3** Bleed function, with valve springs for PP, NP, & PVT - **NOT type 0232**
- 4** Version for highly viscous media, *only PVT type 1005, 1605, 0708, 1008, 0413, 0713, 0220, 0420*
- 9** Self bleed, (SEK) **for PP, NP only - NOT available for types 1000 and 0232 PP = NP =**

Hydraulic Connections

- 0** Standard according to technical data

Design

- 0** With ProMinent Logo

Power Supply

- A** 200 - 230 V, ±10%, 50/60 Hz ***** CAN Bus ONLY *****
- U** 100 - 230 V, ±10%, 50/60 Hz ***** CAN Bus ONLY *****

Cable & Plug

- C** 2m Australian
- 1** 2m Open ended Cable for 12-24V pumps **ONLY**

Relay

- 0** No Relay
- 1** Fault indicating relay (N/C) (changeover relay) **Preferred**
- 3** Fault indicating relay (N/O) (changeover relay)
- 4** As for 1 + pacing relay (1 input each)
- 5** As for 3 + pacing relay (1 input each)

Accessories

- 0** No accessories
- 1** Tube FV & IV - **NOT for PTFE, SS or HV**

- 0** No lock

- 1** With lock: manual operation locked when external cable is plugged in.

Options on request

- D** CANopen for Dulcomarin® II

- 0 0** no option

Prepack Option

- P*** See

Prepacks = P*

P0 - includes 5m of delivery and 2m suction tube a CANbus cable, if specified.

Note: 1601, 1602, 1605 pumps are supplied with 5.0m PTFE tube, other tube is available on request.

BT4a 1601 PPE 2 0 0 A C 0 1 0 0 0 0 P0



1.1 ProMinent® Beta® b 4 & 5 Metering Pumps

1.1.6 Beta® 4b & 5b Spare Parts Sets

		Part No.
Type 1000	PPT, NPT, PVT	1023107
also: 0700, 0400	TTT	1001737
	SST	1001729
Type 1601	PPT, NPT, PVT	1023108
also: 2001, 1001, 0701, 0401	TTT	1001738
	SST	1001730
Type 1602	PPT, NPT, PVT	1023109
also: 2002, 1002, 0702, 0402	TTT	1001739
	SST	1001731
Type 1604	PPT, NPT, PVT	1035332
also: 2504, 1004, 0704, 0404	PVT HV	1035342
	TTT	1035330
	SST	1035331
Type 0708	PPT, NPT, PVT	1023111
also: 1008, 0408	PVT HV	1019067
	TTT	1001741
	SST	1001733
Type 0413	PPT, NPT, PVT	1023112
also: 0713	PVT HV	1019069
	TTT	1001742
	SST	1001734
Type 0220	PPT, NPT, PVT	1023113
also: 0420	PVT HV	1019070
	TTT	1001754
	SST	1001735
Type 0232	PPT, NPT, PVT	1023124
	TTT	1001755
	SST	1001736

Replacement part sets for ProMinent® Beta, consisting of:

- 1x dosing diaphragm
- 1x suction valve
- 1x discharge valve
- 1x set seals
- 1x connector set

Note: Does not include valves for SS

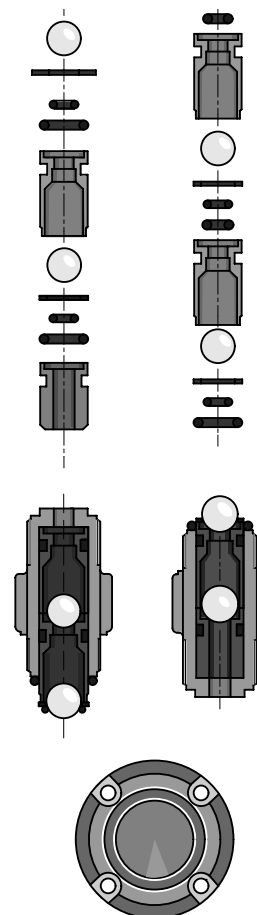

Spare Parts Kits for Solenoid-driven Metering Pump Beta® with Self-bleeding Dosing Head

TYPE SER

		Part No.
Type 100	NPT7, PVT7	1047830
Type 1604	NPT7, PVT7	1047858
Type 0708,1008	NPT7, PVT7	1047832
Type 0413, 0713	NPT7, PVT7	1047833
Type 0220, 0420	NPT7, PVT7	1047837

Replacement part sets for ProMinent® Beta, consisting of:

- 1x metering diaphragm
- 1x suction valve assembly
- 1x discharge valve assembly
- 1x connector set



1.1 ProMinent® Beta® b 4 & 5 Metering Pumps

1.1.7 Beta® 4a/b & 5a/b Spare Parts Sets

Replacement part sets for ProMinent® Beta, consisting of:

- 1x dosing diaphragm
- 1x suction valve
- 1x discharge valve
- 1x set seals
- 1x connector set

Note: Does not include valves for SS

Note: Gamma L Spare Parts Sets are the same as the Beta listed here.

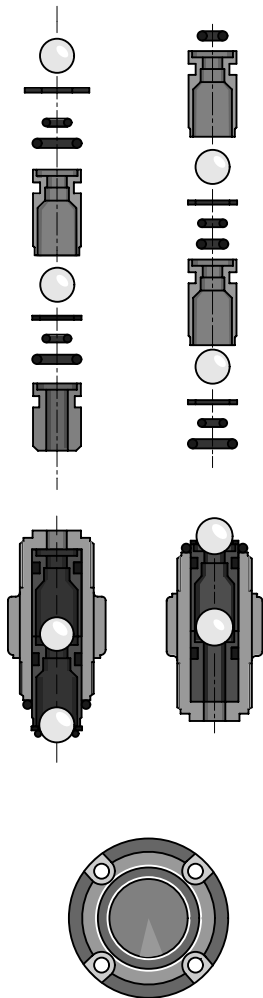

		Part No.	
BT4a/b 1000 also: 0700, 0400	PPE	1001644	
	PPB	1001652	
	PCE/NPE	1001713	
	PCB/NPB	1001721	
	PVT	1023107	
	TTT	1001737	
	SST	1001729	
	BT4a/b 1601 also: 2001, 1001, 0701, 0401	PPE	1001645
		PPB	1001653
		PCE/NPE	1001714
PCB/NPB		1001722	
PVT		1023108	
	TTT	1001738	
	SST	1001730	
	BT4a/b 1602 also: 2002, 1002, 0702, 0402	PPE	1001646
		PPB	1001654
		PCE/NPE	1001715
PCB/NPB		1001723	
PVT		1023109	
	PVT/HV	1035342	
	TTT	1001739	
	SST	1001731	
	BT4a/b 1604 also: 1004, 0704, 0404	PPE	1039989
		PPB	1039987
PCE/NPE		1039988	
PCB/NPB		1039986	
PVT		1035332	
	TTT	1035330	
	SST	1035331	
	BT4a 1005, & BT5a 1605	PPE	1001647
		PPB	1001655
		PCE/NPE	1001716
PCB/NPB		1001724	
PVT		1023110	
	PVT/HV	1019066	
	TTT	1001740	
	SST	1001732	
	BT4a/b 0708 & BT5a/b 1008 also: 0408	PPE	1001648
		PPB	1001656
PCE/NPE		1001717	
PCB/NPB		1001725	
PVT		1023111	
	PVT/HV	1019067	
	TTT	1001741	
	SST	1001733	
	BT4a/b 0413 & BT5a/b 0713	PPE	1001649
		PPB	1001657
PCE/NPE		1001718	
PCB/NPB		1001726	
PVT		1023112	
	PVT/HV	1019069	
	TTT	1001742	
	SST	1001734	
	BT4a/b 0220 & BT5a/b 0420	PPE	1001650
		PPB	1001658
PCE/NPE		1001719	
PCB/NPB		1001727	
PVT		1023113	
	PVT/HV	1019070	
	TTT	1001754	
	SST	1001735	
	BT5a/b 0232	PPE	1001651
		PPB	1001659
PCE/NPE		1001720	
PCB/NPB		1001728	
PVT		1023124	
	TTT	1001755	
	SST	1001736	



1.1 ProMinent® Beta® b 4 & 5 Metering Pumps

1.1.7 Beta® 4a/b & 5a/b Spare Parts Sets

Replacement part set: Beta® with self-deaerating head TYPE SEK

		Part No.
BT4a/b 1601	PPE9	1001756
also: 2001, 1001, 0701, 0401	PPB9	1001762
	NPE9	1001660
	NPB9	1001666
BT4a/b 1602	PPE9	1001757
also: 2002, 1002, 0702, 0402	PPB9	1001763
	NPE9	1001661
	NPB9	1001667
BT4a 1604	PPE9	1035339
also: 1004, 0704, 0404	PPB9	1035336
	NPE9	1035333
	NPB9	1035334
BT4a 1005, & BT5a 1605	PPE9	1001758
	PPB9	1001764
	NPE9	1001662
	NPB9	1001668
BT4a/b 0708 & BT5a/b 1008	PPE9	1001759
also: 0408	PPB9	1001765
	NPE9	1001663
	NPB9	1001669
BT4a/b 0413 & BT5a/b 0713	PPE9	1001760
	PPB9	1001766
	NPE9	1001664
	NPB9	1001670
BT4a/b 0220 & BT5a/b 0420	PPE9	1001761
	PPB9	1001767
	NPE9	1001665
	NPB9	1001671

Replacement part sets for ProMinent® Beta® with self-deaerating head, consisting of:

- 1x dosing diaphragm
- 1x suction valve
- 1x discharge valve
- 1x bleed valve complete
- 2x valve balls
- 1x set seals
- 1x connector set

Note: Does not include valves for SS

Beta®/GALA sizes of NP & PP Liquid Ends These no's engraved on side of Dosing Head

70 x 10	=	1000
70 x 12.5	=	1601
70 x 16.5	=	1602
70 x 20	=	1604
90 x 23	=	1005/1605
90 x 29	=	0708/1008
90 x 37	=	0413/0713
90 x 44	=	0220/0420
110 x 59	=	0232

Replacement diaphragms for Beta® & gamma/ L range

dia.	Model		
30.0	BT4a 1000	all materials	1000244
30.0	BT4a 1601	all materials	1000245
34.5	BT4a 1602	all materials	1000246
35.0	BT4b 1604 1004 & 2504	all materials	1034612
45.0	BT4a 1005 & BT5a 1605	all materials	1000247
45.5	BT4a 0708 & BT5a 1008	all materials	1000248
55.0	BT4a 0413 & BT5a 0713	all materials	1000249
76.0	BT4a 0220 & BT5a 0420	all materials	1000250
91.0	BT5a 0232	all materials	1000251

Replacement O-ring kits for Beta® & gamma/ L range

PPE2 1000, 1601, 1602, 1005, 1605, 1004	EPDM	1001775
0708, 0413, 1008, 0713, 0220, 0420, 0232	EPDM	1001776
NPB2 & PPB2 1000, 1601, 1602, 1005, 1605, 1004	Viton	1001773
0708, 0413, 1008, 0713, 0220, 0420, 0232	Viton	1001774
PPE9 1601, 1602, 1005, 1605, 1004	EPDM	1001674
0708, 0413, 1008, 0713, 0220, 0420, 0232	EPDM	1001675
NPB9 1601, 1602, 1005, 1605	Viton	1001672
0708, 0413, 1008, 0713, 0220, 0420, 0232	Viton	1001673
PVT2 1000, 1601, 1602, 1004	Teflon	1023130
0708, 0413, 1008, 0713, 0220, 0420, 0232	Teflon	1035641



1.1 ProMinent® Beta® b 4 & 5 Metering Pumps

1.1.8 PTFE Diaphragm for Beta® 4a/b & 5a/b

NOTE: To be used ONLY with Chlorine Dioxide

Type	with the medium	Part No.
Type 1602		1118690
Type 1604		1117351
Type 0708 and Type 1008		1117350
Type 0413 and Type 0713		1117354

