

3.1 Accessories ProMinent® Sigma, Vario, Meta, Makro TZ, Foot Valves

3.1 Accessories Meta/Makro TZ - Foot Valves

Description/version

Part no. Price

For connection to the end of the suction line to prevent return flow and to protect the pump from contamination, with strainer and ball check valve. The same materials are used as for the liquid ends. The union nut and union end/hose connector are part of the standard delivery package.

Caution: Foot valves are not suitable as absolutely leakproof isolating elements.

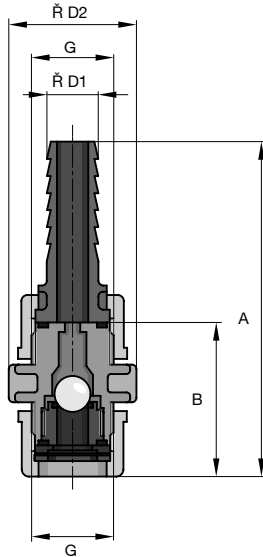

pk_2_026

Foot valve, PVC

Valve body of PVC, seals of Viton, with strainer and ball check-valve

G	Solvent weld male	B	Ø D2	
DN 10	15mm	51	40	P809464
DN 15	20mm	56	47	P924515
DN 20	25mm	67	55	P803723
DN 25	25mm	73	60	P803724
DN 32 PVT	32mm Female	85	74	P1006434
DN 40	32mm	100	90	P1004204

NOTE : BSPM and Hose tail connections also available.

Foot valve, PVDF

Valve body of PVDF, seals of PTFE, with strainer and ball check-valve

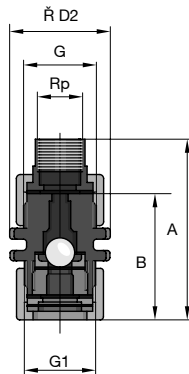

pk_2_027

G	BSPTM	B	SW	ØD2	Part No
DN 10	1/2"	69	30	35	P1029471
DN 15	3/4"	75	36	47	P1029472
DN 20	1"	69	46	57	P1029473
DN 25	1"	75	50	64	P1029474
DN 32	1-1/2"	103	75	89	P1006434-PVT

NOTE: DN32 valve has Hastalloy-C Disc and Spring

Foot valve, stainless steel

Valve body of stainless steel, seals of PTFE, with strainer and ball check valve (1.4571/1.4581)

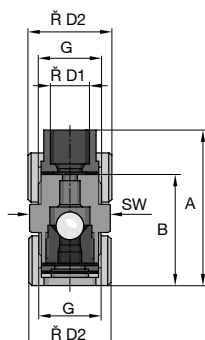

pk_2_025

G1	BSPF	G2	A	B	Ø D2	
DN 10	3/8"	BSP/F	-	48	37	809467
DN 15	1/2"	BSP/F	-	51	48	924518
DN 20	3/4"	BSP/F	-	64	55	P803727
DN 25	1"	BSP/F	-	72	63	P803728
DN 32	1-1/4"	BSP/F	-	82	75	P1006435
DN 40	1-1/2"	BSP/F	-	98	90	P1004206

3.2 Accessories ProMinent® Sigma, Vario, Meta, Makro TZ, Injection Valves

3.2 Accessories - Meta/Makro TZ Injection Valves

Description/version

Part no. Price

For the connection of the pump metering line to the point of injection. The injection valves are equipped with ball check and a Hastelloy C spring (0.5 bar response pressure) and can be installed in any position. They are used for creating pressure and preventing return flow. The same materials are used as for the liquid ends. Union nuts and union ends are part of the standard delivery package.

Caution: Injection valves are not suitable as absolutely leakproof isolating elements.

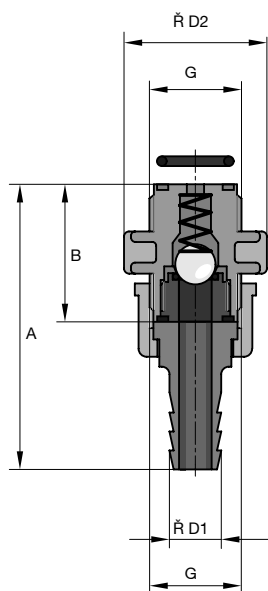

pk_2_029

Injection valve, PVC

Valve body of PVC, seals of Viton, with ball check, spring-loaded, response pressure approx. 0.5 bar

	G	BSPM x solvent weld	B	∅ D2	Part No.	Price
DN 10	3/4"	1/2" x 15mm	51	40	P809460	
DN 15	1"	3/4" x 20mm	56	47	P924520	
DN 20	1 1/4"	1" x 25mm	67	55	P803712	
DN 25	1 1/2"	1" x 25mm	73	60	P803713	
DN 32 PVT	2"	1-1/2" x 32mm female	73	60	P1002783	
DN40	2 1/4"	2" x 32mm			P804760	

NOTE : BSP fittings available for inlet and outlet.

Injection valve, PVDF

Valve body of PVDF, seals of PTFE, with ball check, spring-loaded, response pressure approx. 0.5 bar. **ALL are supplied Male/Male BSP**

G	BSPM x BSPM	B	∅ D2	
DN 10	1/2" BSPTM			PA07002486
DN 15	3/4" BSPTM			PA07002487
DN 20	1"	55	46	PA07002488
DN 25	1"	60	50	PA07002489
DN 32	1-1/2"	85	75	PA07002490

NOTE: DN32 valve has Hastalloy-C Disc and Spring

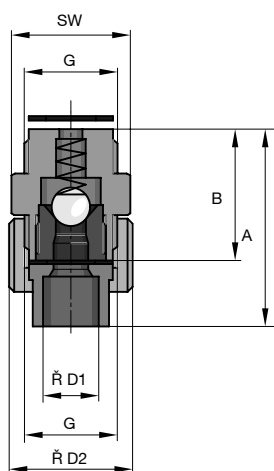

pk_2_030

Injection valve, stainless steel

Valve body of stainless steel, seals of PTFE, ball check, spring-loaded (1.4571/1.4581), response pressure approx. 0.5 bar

G1	BSPF x BSPF	B	∅ D	
DN 10	3/8" BSPF inlet & outlet			P809463
DN 15	1/2" BSPF inlet & outlet			P924523
DN 20	3/4" x 3/4" BSPF	56	56	P803716
DN 25	1" x 1" BSPF	60	59	P803717
DN 32	1-1/4" x 1-1/4" BSPF	60	59	P1002801
DN 40	1-1/2" x 1-1/2" BSPM	85	90	P804763

Injection valve DN 10 for Meta/Makro TZ-HK

Valve body and valve spring of 1.4571 s/s, ball of 1.4401 s/s, seals of PTFE, response pressure approx. 0.1 bar

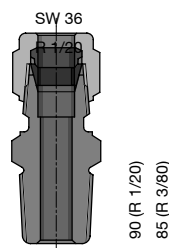

pk_2_028

Rp

Connection 1/4" x 1/2" BSP	803732
Connection 3/8" x 1/2" BSP	803733